



P 21

**Washing machine  
Installation and users' instruction**

***SAVE THESE INSTRUCTIONS FOR FUTURE REFERENCE***



# CONTENTS

SAFETY	1
DESCRIPTION OF THE MACHINE	2
INSTALLATION	2
WARNINGS	2
SETTING-UP THE MACHINE	3
USEFUL ADVICE	4
CLOTHING CARE LABELS	5
BEFORE WASHING	6
USING THE PROGRAMMES	7
FUNCTION BUTTONS	8
MAINTENANCE	9
IF THE APPLIANCE DOES NOT WORK	10
TECHNICAL CHARACTERISTICS	10

ENGLISH

Thank you for having chosen our product.

This appliance is safe and easy to use. It has been constructed according to international safety standards designed to protect the user. In order to familiarise yourself with the machine and ensure its long working life, we strongly recommend that you read this instruction manual carefully.

## IMPORTANT SAFETY INSTRUCTIONS

### WARNING

- \* To reduce the risk of fire, electric shock, or injury to persons when using your appliance, follow basic precautions, including the following:
- \* Read all instructions before using the appliance.
- \* Do not run appliance while you are out of the home.
- \* Do not allow children to play on or in the appliance. Close supervision of children is necessary when the appliance is used near children.
- \* Before the appliance is removed from service or discarded, remove the door to the washing compartment.
- \* Do not reach into the appliance if the drum is moving.
- \* Do not install or store this appliance where it will be exposed to the weather.
- \* Do not tamper with controls.
- \* Do not repair or replace any part of the appliance or attempt any servicing unless specifically recommended in the user-repair instructions or in published user-repair instructions that you understand and have the skills to carry out.
- \* Do not add gasoline, dry-cleaning solvents, or other flammable or explosive substances to the wash water. These substances give off vapors that could ignite or explode.
- \* Under certain conditions, hydrogen gas may be produced in a hot water system that has not been used for 2 weeks or more. **HYDROGEN GAS IS EXPLOSIVE.** If the hot water system has not been used for such a period, before using a washing machine or combination washer-dryer, turn on all water faucets and let the water flow from each for several minutes. This will release any accumulated hydrogen gas. As the gas is flammable, do not smoke or use an open flame during this time.

Do not wash or dry articles that have been previously cleaned in, washed in, soaked

in, or spotted with gasoline, dry-cleaning solvents, cooking oils, or other flammable or explosive substances because they give off vapors that could ignite or explode.

### GROUNDING INSTRUCTIONS

This appliance must be properly grounded. In the event of malfunction or breakdown, grounding will reduce the risk of electric shock by providing a path of least resistance for electric current. This appliance is equipped with a cord having an equipment-grounding conductor and grounding plug. The plug must be plugged into an appliance outlet that is properly installed and grounded in accordance with all local codes and ordinances.

### WARNING

Improper connection of the equipment grounding conductor can result in a risk of electric shock. Check with a qualified electrician or serviceman if you are in doubt as to whether the appliance is properly grounded.

Do not modify the plug provided with the appliance -if it will not fit the outlet, have a proper outlet installed by a qualified electrician.

This manual does not cover every possible condition and situation that may occur. Use common sense and caution when installing, operating, and maintaining any appliance.

### SAVE THESE INSTRUCTIONS

## DESCRIPTION OF THE MACHINE

The washing machine is a domestic appliance capable of washing any type of fabric at any time.

- \* The machine has been constructed in steel panels which have been treated and painted to guarantee that its aesthetic qualities remain unaltered over time.
- \* The motor and all moving parts have been designed and manufactured to guarantee the minimum possible noise levels
- \* The large well-mounted stainless steel drum will ensure a better quality wash and help to prolong the life of your washing
- \* The easy to use control panel will satisfy all your washing and drying needs (see control panel and programme table).
- \* The wide door makes loading and unloading your washing much easier.
- \* The very high stability of the machine is the result of extensive research by our technicians on the equilibrium of masses in movement.

## INSTALLATION INSTRUCTIONS

Installation must be carried out by qualified personnel in line with the instructions supplied by the manufacturer. Incorrect installation may result in damage or injury.

The machine can be installed anywhere providing the ambient temperature is not less than 3°C and the wires or pipes on the rear of the machine are not squashed.

## WARNINGS

For transport reasons, the machine's oscillating group is locked in place by 4 spacers and screws. Before using the machine, remove the locking screws with a suitable wrench.

Insert a screwdriver in the holes and lever out the 4 plastic spacers as shown in the figure. N.B. If the spacers cannot be removed from the machine in this way, open the rear panel, remove them and replace the panel.

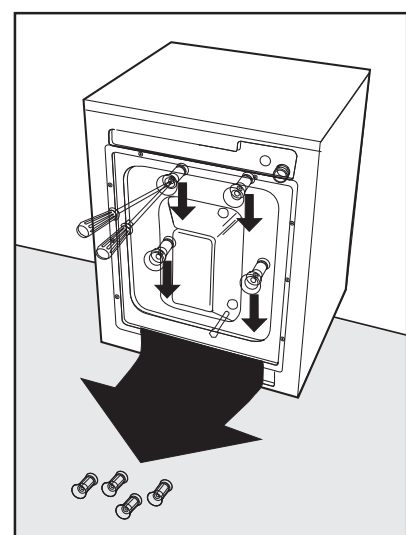
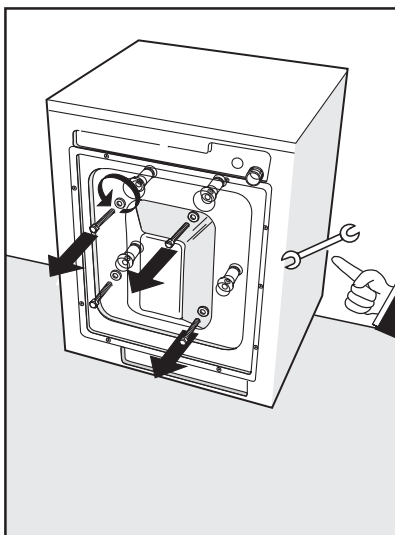

## SETTING-UP THE MACHINE

Place the machine near to the connection points and ensure that it is level.

To do this, adjust the feet by screwing or unscrewing them as required. When the machine is level, tighten the lock nuts on the feet using a spanner.



## ELECTRICAL CONNECTION

Check that the power supply and socket are correctly sized for the maximum load demand of your machine. The power supply voltage is indicated on the rating plate inside the door of the washing machine.

The domestic power supply must be equipped with an earth. If this requirement is not complied with, the manufacturer will not be held responsible for any damage or injury caused.

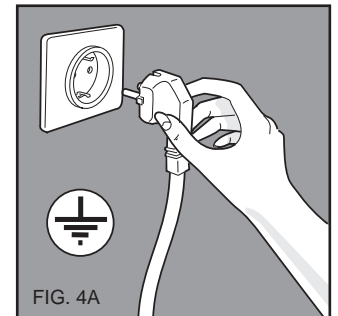

## WATER CONNECTION

Allow a good quantity of water to flow out of the system until it is clear and free of impurities, especially if the plant is new or has not been used for some time. Two separate hoses to two faucets; one hot and one cold.

Connect the hose from the hot water tap to the valve with red filter and the hose from the cold water tap to the other valve. Check that the other end of the pipe is tightened properly.

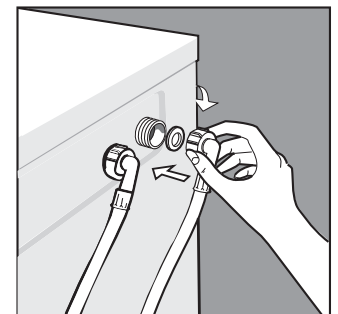
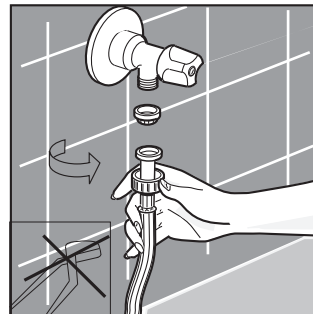

## DRAIN REQUIREMENTS

Position the drain hose between a minimum of 60 cm and a maximum 90 cm from floor level. N.B. To prevent siphoning, do not make the machine drain hose connection air tight.

If the water system is not provided with a drain, use the bracket supplied to position the drain pipe over a washbasin then tie it to a tap.

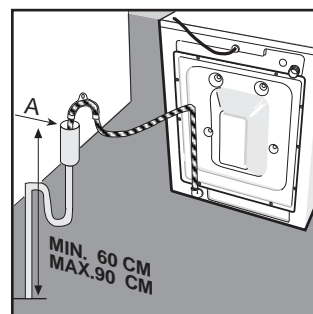

## USEFUL ADVICE

- \* Separate the washing according to type of fabric.
- \* Wash coloured and white articles separately.
- \* Check the clothing care labels affixed to the articles and set the appropriate programme and temperature.
- \* In order to obtain good results from the wash, distribute the washing evenly inside the machine alternating small items with larger ones.
- \* In order not to waste water, energy and detergent, it is advisable to load the machine to its maximum recommended capacity.
- \* Do not use the pre-wash unless it is strictly necessary. This will reduce water, energy consumption and time by an average of 10%.
- \* Try to avoid overloading the machine with articles in towelling only.
- \* Carefully check that there are no objects left in the pockets of the articles to wash as these may block the drain pump.

Stains exist that cannot be removed by machine washing alone.

The following paragraphs describe how to pre-treat stained fabrics before loading them in the machine. This will help prevent an unsuccessful wash and the formation of stain rings.

- \* Wax: Scratch away as much of the wax as possible using a blunt knife, then iron with a piece of silk paper between the iron itself and the stained item.
- \* Ball-point and felt-tip pens: Dab the stain with a cloth dampened with 90° colourless alcohol. Take care not to increase the stain.
- \* Ironing marks: If the fabric is discoloured, follow the same procedure described for “damp and mould” stains.
- \* Rust: Use a rust remover, carefully following the manufacturer’s instructions.
- \* Chewing gum: Dilute it with acetone and remove using a clean cloth.
- \* Paint: Do not allow the paint to dry. Treat it immediately with the solvent indicated on the paint container (water, Turps, trichloroethylene), soap it and rinse.
- \* Lipstick: Dab it with ether if the stain is on wool or cotton or use trichloroethylene if on silk.
- \* Nail varnish: Place the stained part of the item over a sheet of absorbent paper and then dampen the reverse side of the item with acetone, frequently changing the absorbent paper under the stain. Repeat the procedure until the stain has disappeared.
- \* Metal stain: Apply lemon juice until the stain has disappeared or greatly reduced in intensity.
- \* Grass: Soap it delicately and treat with diluted bleach.  
For woollen items, 90° alcohol can produce good results.

# HOW CAN I WASH ALMOST ANYTHING?

**Tennis shoes.** Tennis shoes or plimsolls can be machine washed. Just remove any mud from them before starting the wash cycle.















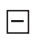









**Net curtains** should be washed alone. They should first be folded, to stop them creasing excessively, and then placed in a net bag or pillowcase.

**Quilted wind-cheaters** can be machine washed. In this case limit the maximum machine load to just over 50%. It is also advisable to carry out an extra rinse at the end of the wash cycle.

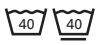
**Printed T-shirts and shirts** will last longer if washed inside out.

## CLOTHING CARE LABELS

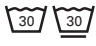
Learn to recognise the symbols on the clothing care labels to obtain a better wash and ensure that the articles have a longer life.

Washing	Bleach	Ironing	Dry cleaning	Drying
 Resistant fabric	 Bleach in cold water	 Iron up to 200° max	 Dry clean with solvent	 Dry flat
 Delicate fabric	 Do not bleach	 Iron up to 150° max	 Do not dry clean	 Hang to dry
 Wash up to 95°C		 Iron up to 100° max	 Dry clean only with: perchloride, aviation fuel pure alcohol, R 111 and R 113	 Dry on clothes hanger
 Wash up to 60°C		 Do not iron	 Dry clean only with: aviation fuel, pure alcohol and R113	 Machine dry at normal temperature
 Wash up to 40°C				 Machine dry at low temperature
 Hand wash				 Do not machine dry
 Wash up to 30°C				
 Do not wash in water				



# BEFORE WASHING

Before each wash ensure that:

- the water connections are correct, the drain hose is properly positioned (see water connection) and that the feed valve is open

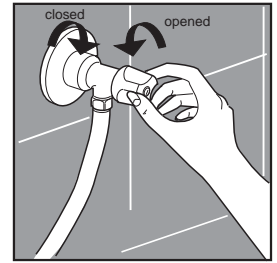

- with dry hands, insert the plug in the mains socket.
- sort the wash into types of fabric (refer to clothing care symbols).

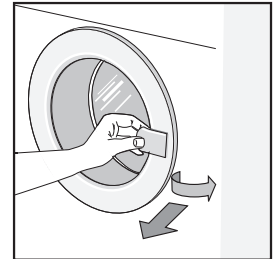

check that there are no objects left in any of the pockets of the items to wash, as these may damage the washing, the appliance or the filter.

- open the door
- load the washing and close the door.

N.B. When adding detergent to the dispenser, remember to avoid any spillage into the softener compartment, in that this would create a soapy rinse and stain the fabrics white. Vice versa, if softener is added to the detergent compartment, the quality of the wash will be compromised.

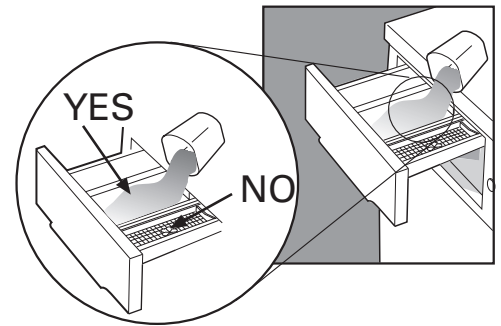

## IF FORESEEN CONTAINER LIQUID DETERGENT

N.B. When using a liquid detergent (recommended for programmes without pre-wash), use the special container (if provided) and follow the manufacturer's instructions. Remember to remove the liquid detergent container when using soap powder.

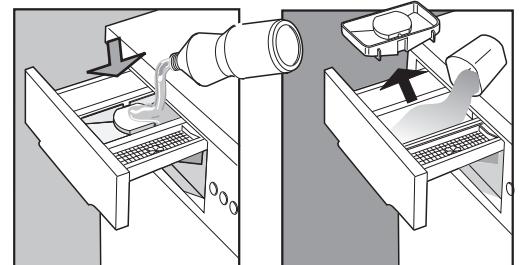

- add low-suds detergent and softener (if required) recommended for automatic washing machines. Follow the dosage instructions written on the packet. N.B. Excessive softener can damage the washing.

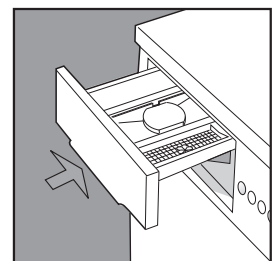

- close the detergent dispenser drawer. Warning! do not attempt to remove the detergent drawer while the appliance is operating, as this will cause water to flow out.





- Select the required programme and temperature according to the programme table.

# OPERATING INSTRUCTIONS

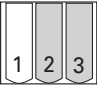
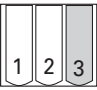
**WARNING - To reduce the risk of fire, electric shock, or injury to persons, read the IMPORTANT SAFETY INSTRUCTIONS before operating this appliance**

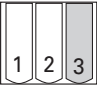
Knob (P)*	Temp options	Dispenser compartment	Examples and degree of soiling	Quantity in	Program description	Spin speed	Use of supplementary buttons		
							WARM RINSE	EXTRA RINSE	NO SPIN
PREWASH	Any		To rinse or refresh articles fabrics that have not been used for some time	Up to 5	Wash for about 5 min.	NO	NO	NO	NO
SUPERWASH	Any		Sheets, white and solid colour tablecloths, towels, underwear; normal soil	Up to 5	Main wash, in about 55 min. with hot water rinses, softener, empty and final spin	1000	As required	As required	As required
REGULAR WASH	Any		For articles in cotton, linen or jute with colours that may run.	Up to 5	Main wash, in about 35-40 min. rinses, softener, empty and final spin	1000	As required	As required	As required
RINSES	Cold		To rinse or refresh articles fabrics that have not been used for some time	Up to 5	Rinses, softener, empty and final spin	1000	As required	As required	As required
DRAIN SPIN	—	—	Intensive spin	Up to 5	Empty and final spin	1000	NO	NO	As required

Knob (P)*	Temp options	Dispenser compartment	Examples and degree of soiling	Quantity in kg	Program description	Spin speed	Use of supplementary buttons		
							WARM RINSE	EXTRA RINSE	NO SPIN
QUICK WASH	Any		For articles in cotton, linen or jute very little dirty.	Maximum 2,5	Main wash, in about 35-40 min, with cold and hot water, rinses, softener, empty and final spin	800	As required	As required	As required
RINSES	Cold		To rinse or refresh articles fabrics that have not been used for some time	Maximum 2,5	Rinses, softener, empty and final spin	800	As required	NO	As required
DRAIN SPIN	—	—	Delicate spin	Maximum 2,5	Final spin	800	NO	NO	As required

Knob (P)*	Temp options	Dispenser compartment	Examples and degree of soiling	Quantity in kg	Program description	Spin speed	Use of supplementary buttons		
							WARM RINSE	EXTRA RINSE	NO SPIN
WOOL / HAND WASH	Any		Machine washable wool	Maximum 1	High water level wash, in about 35 min rinses, softener, empty and final delicate spin	500	As required	As required	As required

\* Position of programmer knob

# FUNCTION BUTTONS

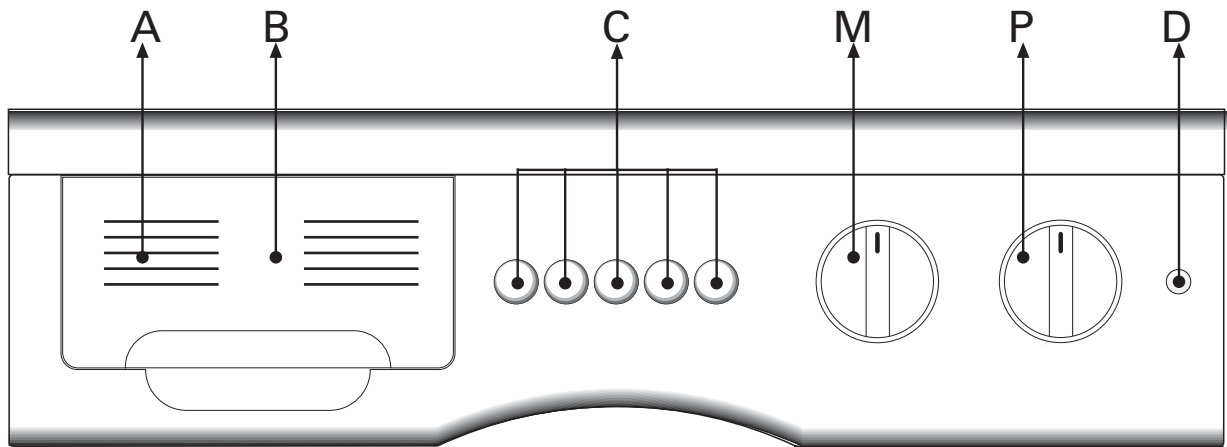

A- PROGRAM TABLE

B- DETERGENT DISPENSER

C- PUSH BUTTONS

D- PILOT LAMP

P- PROGRAMMER KNOB

M- TEMPERATURE CONTROL KNOB

## Selecting the program and start-up

Select the program you require by turning the knob until the indicator coincides with the number of the program to be selected. The machine will start-up when the button or the knob are in the position "1" or "ON".

## Temperature control knob

The temperature Control Knob lets you select the best wash temperature for each load. The temperature options are restricted on some of the programs (as show in the table on page 7).

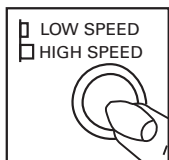

### SPIN SPEED ADJUSTMENT BUTTON

This function allows the spin speed to be altered by pressing the button

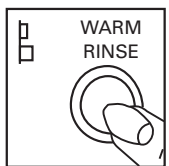

### WARM RINSE BUTTON

Press this button to have last rinse warm. This function only on regular and perma press cycles.

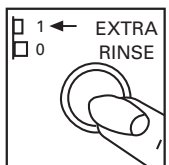

### EXTRA RINSE BUTTON

The washing machine has been set up so that water consumption is reduced to a minimum; three rinses are usually sufficient. If desired, it is possible to use an additional rinse cycle, by selecting the button

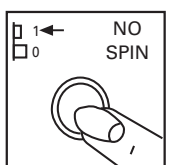

### NO SPIN BUTTON

To avoid any kind of spin select this button

# USER-MAINTENANCE INSTRUCTIONS

## INTRODUCTION

The washing machine is a domestic appliance that does not need any special maintenance in that it has been designed and built to last. Nevertheless, some precautions do need to be taken (see chapter on warnings).

When carrying out the following operations, make sure that the plug has been removed from the mains socket and that the water feed valve is closed.



## PERIODIC CLEANING OF THE DRAWER

The machine must not be cleaned with solvents, but merely using a damp and slightly soapy cloth. The drawer should be cleaned whenever residual detergent starts to build up.

To extract the drawer, simply pull it from its housing and then clean it under running water.

## CLEANING THE PUMP FILTER

This operation should be carried out at least once a month. When cleaning the filter, make sure that there is no water left in the drum.

The operation is carried out by placing a shallow container or rag under the filter door to catch any water that may spill out. Remove the filter from its housing by turning it anticlockwise half a turn and then pulling outwards.

The filter is cleaned by holding it under running water and ensuring that all the deposits are removed. Then replace the filter in its housing, turning it clockwise. Make sure that it is seated properly and locked in its housing.

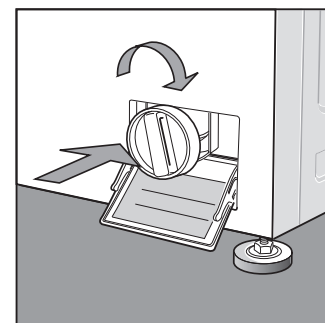
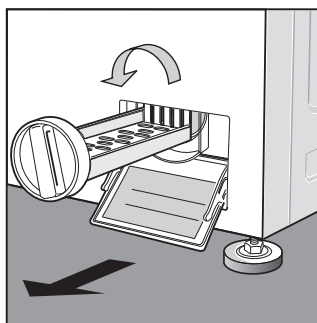
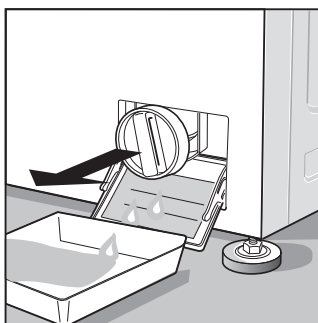

## IF THE APPLIANCE DOES NOT WORK

Before calling for assistance, check that the operations described below have been carried out correctly as this will save both time and money.

### It will not start (indicator light off)

Make sure that:

- 1) Mains power is available
- 2) The plug is inserted properly in the socket
- 3) The programmer knob has been pulled out, or the on/off button where fitted has been pressed (using the washing machine).
- 4) The door is closed

### It does not fill with water

Make sure that:

- 1) There is water in the supply system
- 2) The valve is open
- 3) There are no kinks in the feed hose
- 4) With the appliance disconnected from the mains, clean the inlet filter between the valve and the water feed hose.

### It will not drain or spin

Make sure that:

- 1) The drain hose is positioned correctly
- 2) There are no kinks in the drain hose
- 3) The quantity of detergent is not excessive
- 4) The detergent dispenser drawer is not blocked with detergent
- 5) The detergent is that recommended for washing machines

### The door will not open

- 1) Wait three minutes after the programme has finished

Try to start the appliance again to see whether the problem has been solved.

If the problem persists, call the service centre stating:

- 1) The type of problem
- 2) The washing machine model
- 3) The serial number of the machine reported on the rating plate inside the filter door

### It will not start (with indicator light on)

Make sure that:

- 1) The programmer knob is set on the required programme
- 2) See problem "does not fill" with water

### I cannot see any water during the wash

This is simply because the new technology used in the machine guarantees double the wash with half the water, the environment is protected and you save energy.

### I can see too much foam

Make sure that:

- 1) The detergent is designed for washing machines

### It vibrates or is noisy

Make sure that:

- 1) Large items have not become tangled (sheets, tablecloths, etc.)
- 2) The washing machine is properly levelled
- 3) The four transport screws and spacers have been removed.

## TECHNICAL CHARACTERISTICS

DIMENSIONS	Width 59,5 cm - Height 85 cm - Dept 53 cm
WATER PRESSURE	0,05 MPa minimum - 1MPa maximum
WEIGHT OF CLOTHES	5 kg
ELECTRICAL DATA	See plate with technical features inside the door
MAXIMUM SPIN SPEED	1000 Rpm





